



TERMINATE

FIRE SAFETY SOLUTION



TECHNICAL DATA

Installation & Operation

www.terminatefire.com

1. Introduction

This technical document consists of fire extinguisher device structure and principle, installation instructions, operation, application, packaging, etc.

The Terminate Device can extinguish A, B,C,E,F class fires. When a fire occurs in a home, supermarket, hotel, school etc many traditional extinguishing can not extinguish the fire in time and many fire extinguishing Terminate Device Fire extinguishing need to be used by people who have very little professional training. Aiming to address these issues, we developed a new fire extinguishing Terminate Device extinguisher ball. Small and compact, light weight and spherical in shape, it can extinguish a fire very quickly. Even the elderly and small children can use it easily. The fire extinguisher device doesn't need maintenance, which is also cost effective. The life of the product is 5 years. The noise can also alert people to evacuate the room and call the fire department when the Terminate Device fire extinguisher Terminate Device is activated. The production and test standard of FREEZE FIRE dry powder is ISI Certified.

2. Structure & Principle

(A) structure The dry powder fire extinguisher Device consists of internal drive Terminate Device, foam shell, installation brackets, ABC dry powder extinguishing agent and PVC plastic covering.

(B) Principle The dry powder fire extinguisher Terminate Device consists of foam shell, internal dry powder, drive Terminate Device and ABC dry powder extinguishing agent. There is a lead wire around the dry powder fire extinguisher Terminate Device. When the lead wire is ignited, the drive Terminate Device is activated and will expand quickly in the shell. The dry powder extinguishing agent will activate when it comes in contact with a naked flame and the dry powder will be sprayed outwards quickly, blanketing and suffocating the fire. The fire will be put out under the physical and chemical effect of extinguishing agent.

3. Technical Specifications

Model	Terminate 1500D	Terminate 1500D1	Terminate 1500D2
Weight (kg)	1 kg	1.5 kg	2 kg
Weight of extinguishing agent (kg)	900 g	1.4 kg	1.8 kg
Diameter (mm)	375	425	460
Protection area (m ²)	<5	<6	<8
Activation time (s)	<10	<10	<10
Noise (dB)	<95 dB	<95 dB	<95 dB
Working temperature (°C)	- 40 + 90	- 40 + 90	- 40 + 90
Validity (Year)	5	5	5

4. Product Packaging and Labelling (Custom Branding and Generic)



FIRE SAFETY EQUIPMENTS

- Fire extinguishers considered as the primary first aid equipment.
- Used to control small fires before it becomes large.
- Works automatic no needs of manual supervision
- Buy Now with lowest and reasonable price.



APPROVED BY :



(Accredited Powder)



Non Toxic to humans



Service Free & 5yr. Warranty



Tested & Certified



Compact & Lightweight



Easy to Operate

APPROVED BY: -

Tested by- NTH (Government Of India)

Tested by- Fire Taste And Research Laboratory. NABL Accredited



5. Operation Procedure

There are two ways the fire extinguisher device can be used :

1. Automatic : Install the dry powder Terminate device and bracket in a fire prone area; above kitchen stove or electrical outlets. Upon flame contact, the fire will ignite the lead wire, activating the fire ball and dispersing dry powder to put the fire out.



2. Manual : The device can be manually thrown into a fire. The dry powder fire extinguisher ball will activate in 5-15 seconds upon flame contact and extinguish the fire. Ignition temperature is 70°



6. Recommended Application

There are many uses for the FREEZE FIRE fire extinguisher device;

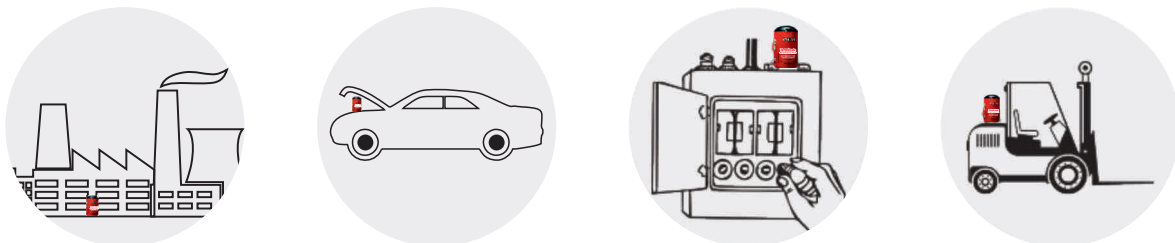

- Residential, commercial and hotel kitchens
- Car boot or engine, boats, caravans
- Industrial sites; warehousing, heavy machinery, manufacturing
- Electrical switch boards and circuit boards
- Server rooms
- Marine Industry including ports
- Exhibition centers
- Public transport; bus engines and luggage compartments, trains, taxis
- Recreational; restaurants, camping, festivals, theme parks, formula one
- Schools and hospitals
- Places of religion
- Petrol Stations
- Emergency services
- Construction
- Retails; supermarkets and hardware houses
- Car manufacturing
- Mining
- Government
- Banking

7. Installations & Maintenance

There are 3 methods to install the dry powder fire extinguisher Terminate Device;

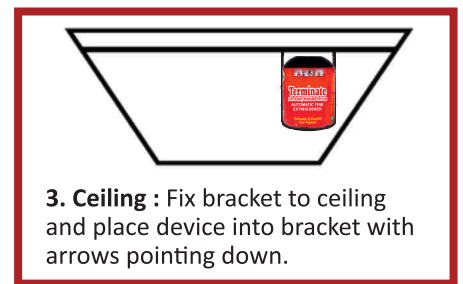
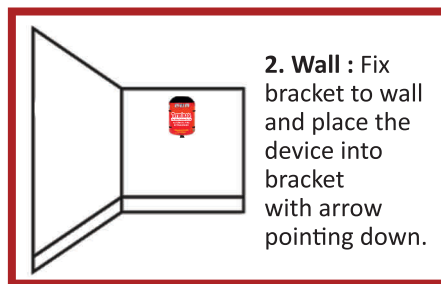
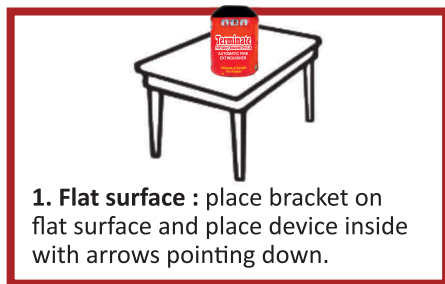

1. Place the dry powder fire extinguisher device into the bracket, put the bracket in any designated location.
2. Place the dry powder fire extinguisher device into the bracket, install the bracket on to any wall with M4 tapping screw.
3. Place the dry powder fire extinguisher device into the bracket, hang the bracket on the ceiling with M4 tapping screw.

8. Maintenance

1. Clean (dry, non-abrasive cloth) and dust regularly. Replace immediately if any damage is found.
2. No need to check or service the quality of dry powder during the period of validity which is 5 years.
3. The validity period of dry powder fire extinguisher Terminate Device is 5 Years.

9. 5 Year Guarantee

The FREEZE FIRE fire extinguisher device has a manufacturers guarantee of 5 years, please refer to expiry date on the device.

10. Training

There is no special training required to operate the dry powder extinguisher device.

11. Disposal

Disposal should be in accordance with applicable regional, national and local laws and regulations.

12. Cleaning Method

Sweep up or use a vacuum cleaner.



Salient Features



- Automatic Activation
- Light in weight
- Mobile
- Compact in size
- Extremely easy to use
- Lightning fast in operation
- Not hazardous
- Bio-degradable
- Residuals 100% recyclable
- Negligible installation
- Ozone friendly
- Non toxic
- 5 Years warranty
- No maintenance required
- 0% false alarm
- Electrically non conductive
- Give an alarm alerting you of danger
- Low clean up required
- Not harmful to humans, animals & environment
- Works on fires inside and outside
- No wiring and ducting required
- Works on most types of fires (A, B, C)
- Designed to work automatically and manually
- Any age group can activate

Terminate Device is an Automatic & Portable Fire Extinguisher, Which acts Immediately in Fire Emergencies



TERMINATE-1000
CE Certification No. - CE010595/0519
Gross Weight - 1.00 kg
Net Weight - 900 g
Material Compliance To -
EN1568-3 & EN1568-4
Type - Dry Powder (Mono Ammonium)



TERMINATE-1500
CE Certification No. - CE010595/0519
Gross Weight - 1.5 kg
Net Weight - 1.4 kg
Material Compliance To -
EN1568-3 & EN1568-4
Type - Dry Powder (Mono Ammonium)



TERMINATE-2000
CE Certification No. - CE010595/0519
Gross Weight - 2.00 kg
Net Weight - 1.8 kg
Material Compliance To -
EN1568-3 & EN1568-4
Type - Dry Powder (Mono Ammonium)



Non Toxic
to humans



Service Free &
5yr. Warranty



Tested &
Certified



Compact &
Lightweight



Easy to
Operate'

Comparison Chart

Particulars	Terminate Device 1500D	Sprinkler	Pressure Cylinder Extinguisher		
			Water Based	Powder Based	
Usage	Automatic & Manual	Automatic	Manual	Manual	
Training	No Training Required	No Manual Operation	Training Required	Training Required	
Maintenance	5 Year Maintenance Free	Routine/Complex Maintenance	Routine/Periodical	Routine/Periodical	
Activation Time	3-8 Seconds	10-15 Second	N/A	N/A	
Malfuction	Zero	High	High	High	
Activation Method	Open Fire	Smoke	N/A	N/A	
Installation Time & Cost	Minimum	High	Medium	Medium	
Extinguished Effect	Moist	Wet	Wet	Dry	
Cleaning Effort	Very Low	Very High	High	Extremely High	
Weight	1 kg / 1.5 kg / 2 kg	N/A	5-10 kg	2-5 kg	
Mobility	Yes	No	Yes	Yes	
Health & Environment Implications	Harmless	Harmless	Harmless	Harmful	
Aesthetics	Good	Good	Poor	Poor	
Warning Signal	Yes	No	No	No	
Reaction Time	Fast	Medium	Slow	Slow	
Method of Action	Cooling, Cutting Oxygen & Blacketing	Cooling	Cooling & Blanketing	Block Chemical Reaction	
Probability of reigniting	Low	Low	Low	Medium	
Usage Distance	Safe Distance	No Approach	Close/High Risk	Close/High Risk Distance	
FIRE CLASS					
A	Wooden Material	Good	Good	Good	Bad
	Paper, Textile	Good	Good	Good	Bad
	Bed Linen	Good	Good	Good	Bad
	Rubber, Celluloid	Good	Good	Good	Bad
	Plastic	Good	Good	Good	Bad
B	Gasoline	Good	Bad	Bad	Good
	Kitchen Fats	Good	Bad	Bad	Good
	Other Oils	Good	Bad	Bad	Good
C	Gases	Good	Bad	Bad	Good
D	Electrical Devices & Installation	Extinguishing	Extinguishing Good	Danger of	Extinguishing Good
		Good / Low	High Consequential	Electrocution / High	High Consequential
		Damage	Damage	Consequential Damage	Damage

TERMINATE FIRE, WITH EASE !



TERMINATE FIRE SAFETY SOLUTION PVT. LTD.

Factory : Gat No. 189/2 Shirdi-Hydarabad Road,
Kharda, Tal. Jamkhed, Dist. Ahmednagar-413204 (MH)

✉ sale.terminatefire01@gmail.com
terminatefire@gmail.com

🌐 www.terminatefire.com

☎ 7499741916/9021570563/9923868690/ 9822293825

📘 Facebook : Terminate Fireoff
📷 insta : terminatefiresafetysolution
🐦 Twitter : Terminate Fire Safety Solution
📺 Youtube : Terminate Fire Safety Solution